

# AT-HEIGHT VACUUMING PIPE KIT INSTALLATION FLOWCHART

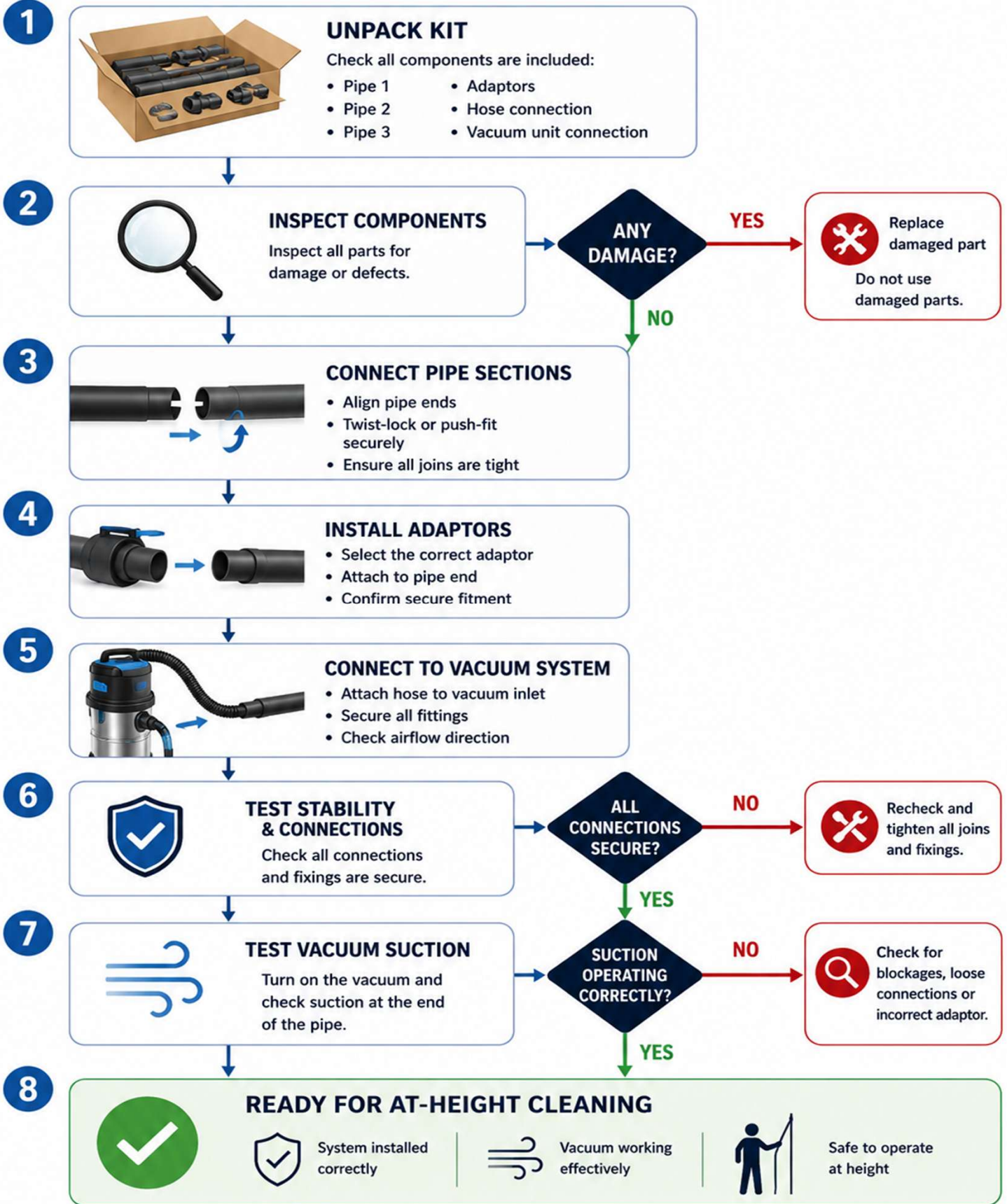

**SAFETY FIRST**

Always follow your site safety procedures and use appropriate PPE when working at height.



# ***AT-HEIGHT VACUUMING PIPE KIT – Set up Guide***

- 1. UNPACK KIT
  - - Check all components included:
  - - Pipe 1, Pipe 2, Pipe 3
  - - Adaptors
  - - Hose connection
- 2. INSPECT COMPONENTS
  - - Inspect all parts for damage or defects.
  - - Any damage? Replace damaged part.
- 3. CONNECT PIPE SECTIONS
  - - Align pipe ends, use clamps to lock in place ( Pic: 1 )
  - - Twist-lock or push-fit securely
  - - Ensure all joins are tight
- 4. INSTALL ADAPTORS
  - - Select correct adaptor ( 32 OR 38MM ) – ( Pic: 2 )
  - - Attach to pipe end ( tool configuration)
  - - Confirm secure fitment
- 5. CONNECT TO VACUUM SYSTEM
  - - Attach hose to vacuum inlet
  - - Secure all fittings
  - - Check airflow direction
- 6. TEST STABILITY & CONNECTIONS
  - - Check all connections and fixings are secure
  - - If not secure: recheck and tighten all joins
- 7. TEST VACUUM SUCTION
  - - Turn on vacuum and check suction
  - - If issues: check blockages or loose connections
- 8. READY FOR AT-HEIGHT CLEANING
  - - System installed correctly
  - - Vacuum working effectively
  - - Safe to operate at height

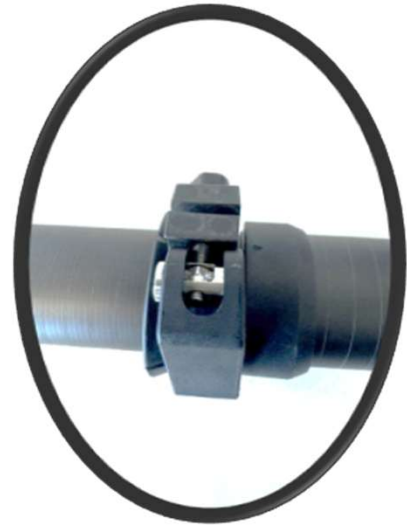

Tool Configuration: Options 32mm & 38mm

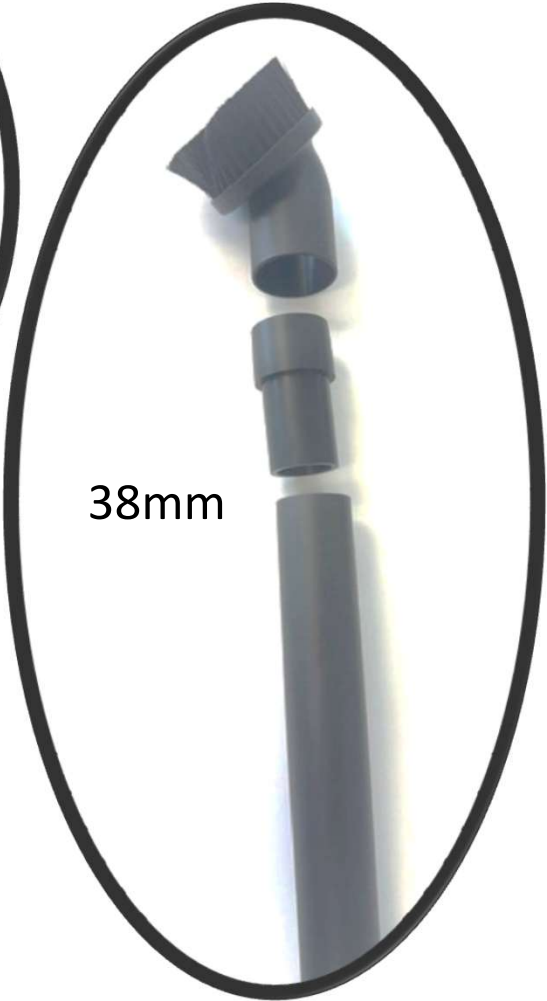
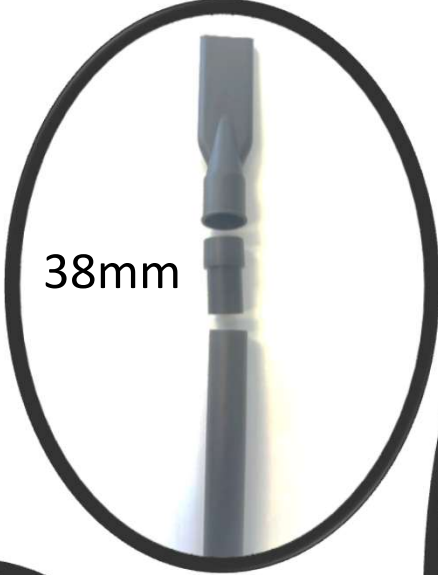
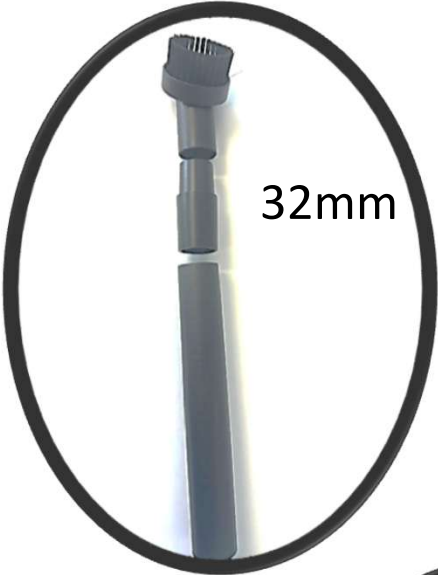

Right Angle with Tools: